



AuG Kiel

Arbeits- und Gesundheitsschutz Kiel



Product Information

Universal Attachment Point U/S-WEA

AuG Kiel GmbH • Warnauer Weg 4 • 24245 Kirchbarkau
Tel.: 04302/9691604 • Fax: 04302/9691605 • www.AuG-Kiel.de

Low level and horizontal rescue

The U/S-WEA Universal Attachment Point provides a wide range of installation possibilities in climbing systems

AuG Kiel Betriebs GmbH is the manufacturer and distributor of the AuG-LifeGuard 360° rescue system. Practically tested and economical systems for rescuing persons from low levels can only be rarely found in wind energy plants. Because of this, operators of wind turbine often have problems, e.g. when rescuing persons from a foundation cellar (onshore) or from a monopile (offshore).

Because of this, AuG Kiel decided to develop a new rescue system: The AuG-LifeGuard 360° rescue system combines two components: the **Universal Attachment Point U/S-WEA** and the SWI-TEC 360° Rescue On-/Offshore drum winch. Both system components simplify the rescue of injured persons from low levels.

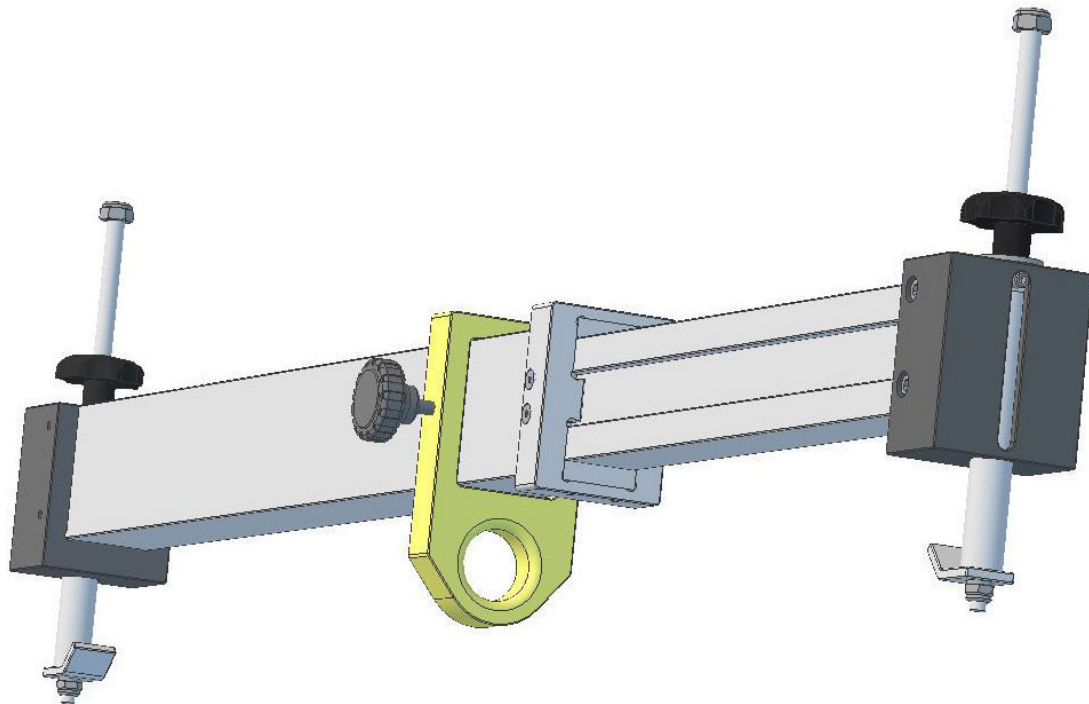

The U/S-WEA Universal Attachment Point is a Type B attachment point which was developed and tested according to DIN EN 795:2012. It was developed and patented for use in ladder systems for wind turbine in onshore and offshore areas. The components consist of a rectangular section aluminium tube with a solid, telescoping internal rectangular beam. The contact surfaces at the ends are equipped with clamping devices and are made of unbreakable plastic, which prevent damage during transport or to the surrounding elements during installation. The actual attachment point with an integrated mounting eye is made from solid aluminium and must be fixed and fastened at its middle point, depending on the extended length, in order to bear the load of the approved connections.

The Universal Attachment Point is used for mobile height positioning in the ladder systems of wind energy plants. Because manufacturers use various vertical ladder systems in wind energy plants, or these systems differ due to local conditions, a high priority was placed on the universal installation capability in the vertical ladder systems of wind energy plants. The length of the Universal Attachment Point can be telescopically adjusted and can therefore be adapted to different spacings of the ladder brackets. The attachment point is approved for use with one person. All approved systems for attachment points compliant with DIN EN 795:2010 Type B with a maximum load of 150 kg can be hooked onto the attachment point.

1. Installation sequence

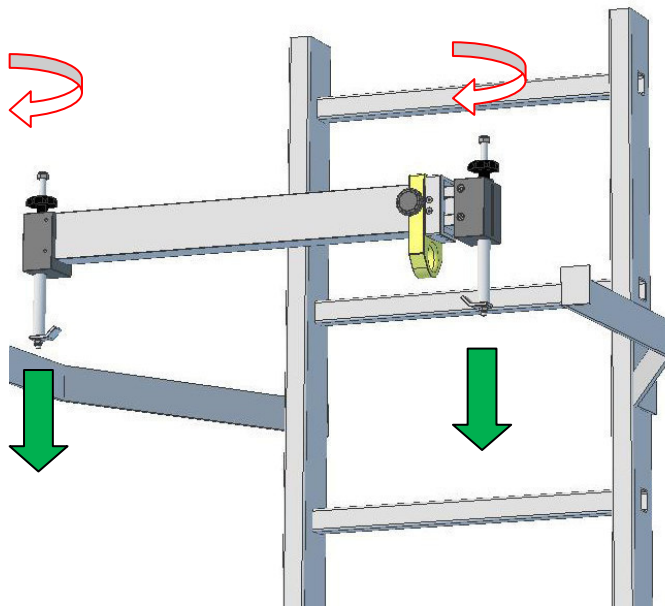

An approved and tested safety harness with a restraining system must be used for installation and assembly. The U/S-WEA Universal Attachment Point must be positioned above the ladder bracket with the clamping device extended.

2. Installation sequence

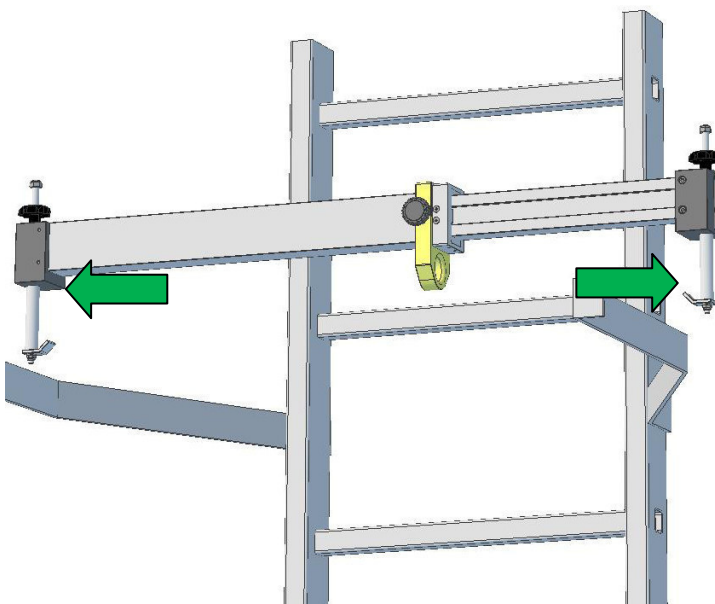

The U/S-WEA Universal Attachment Point is extended to the required length with the aid of the telescopic adjustment. The clamping devices must be located **outside** of the ladder bracket.

3. Installation sequence

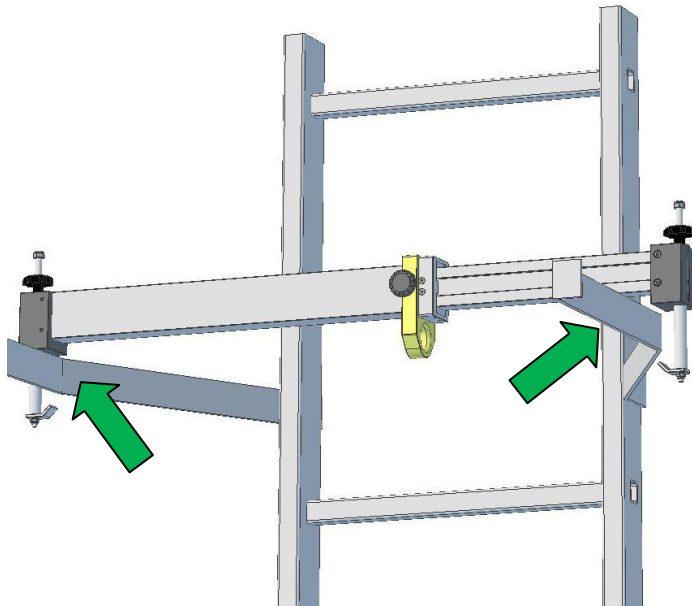

The U/S-WEA Universal Attachment Point is now placed on both of the ladder brackets.

4. Installation sequence

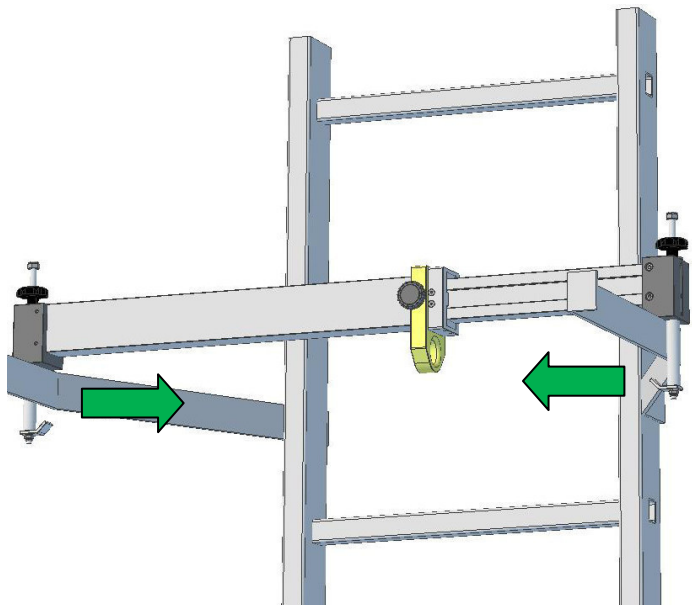

Both clamping devices are now pushed towards the middle, until they make contact with the ladder brackets. The contact surfaces must now lie on the ladder bracket.

5. Installation sequence

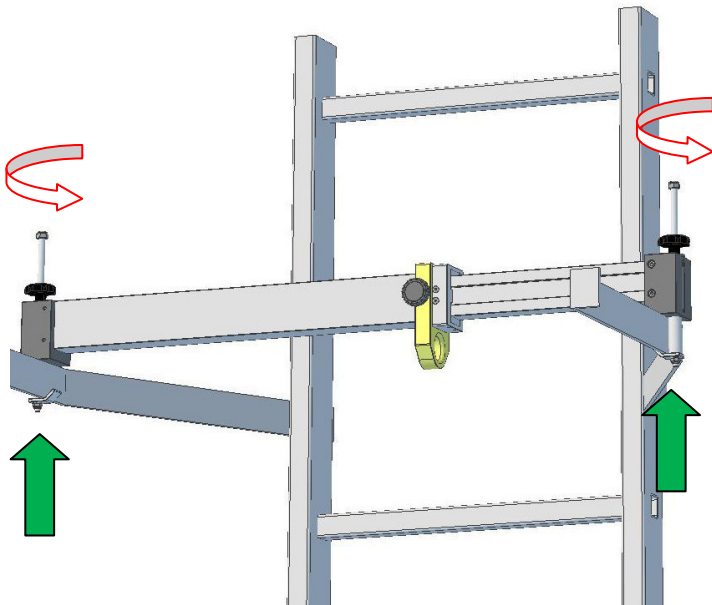

After adjustment, the U/S-WEA Universal Attachment Point is now clamped to the ladder brackets by turning the star handles of the relevant clamping device. The clamping lugs must surround the bottom side of the vertical ladder mount, in order to securely tighten the U/S-WEA Universal Attachment Point.

6. Installation sequence

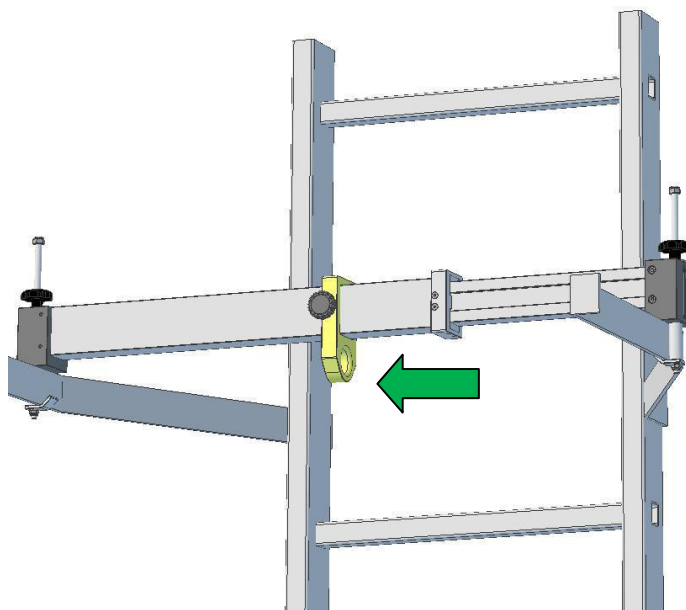

Finally, the attachment point is pushed to the middle by loosening the knurled handle and is then fixed again.

Technical data

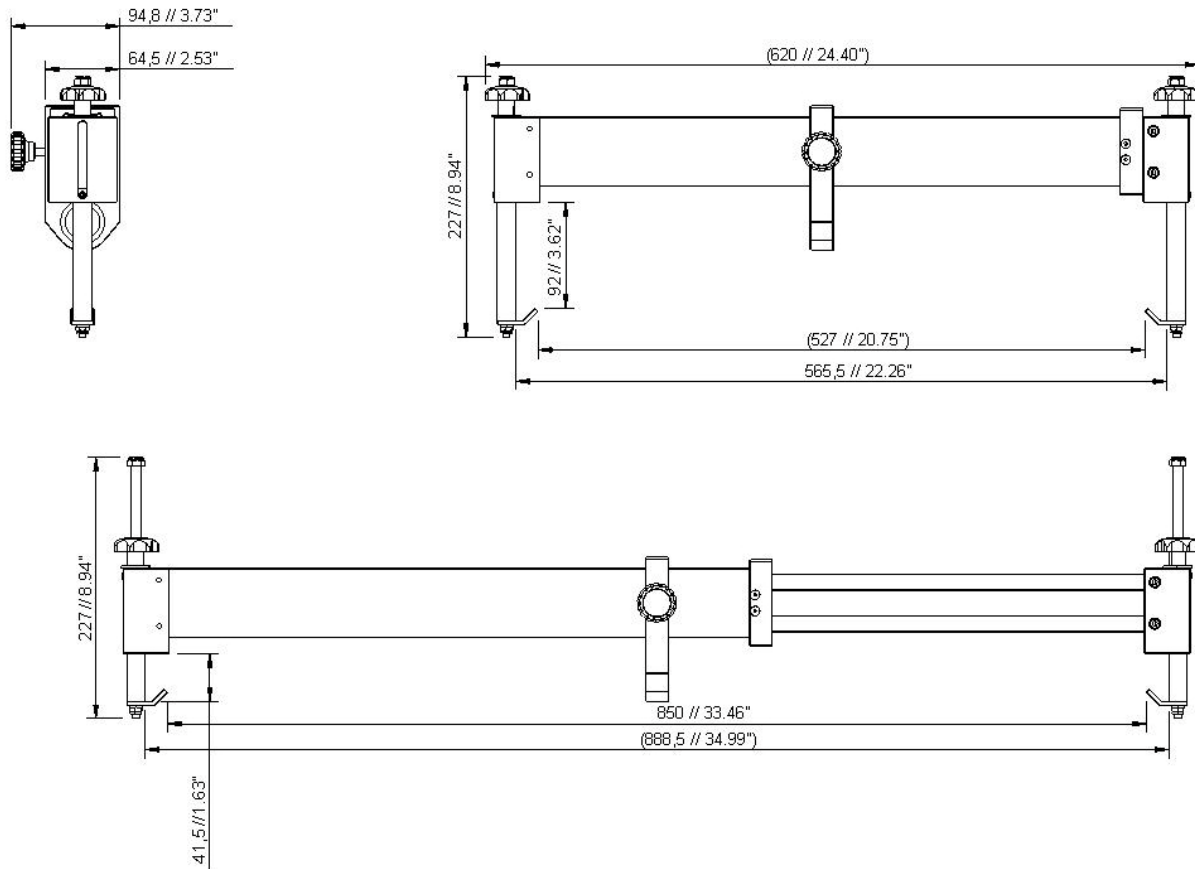

Illustration: Dimensions in [mm] and [Inch]

Permissible duration of use:	10 years, extension by 2 years on inspection by the manufacturer
Inspection interval:	Annually by qualified person 5-year interval (by manufacturer)
Permissible number of persons:	1 Person / max. 150 kg
Load bearing capacity of ladder bracket:	min 7,5 kN (750 kg)
Weight of universal attachment point:	3,6 kg
Main dimensions (retracted)	603,5 x 94,8 x 217 [mm]
Main dimensions (extended)	926,5 x 94,8 x 217 [mm]
Materials used for the Universal Attachment Point U/S-WEA:	EN AW-6060, POM-C, X5CrNiMo17-12-2 (V4A)
Permissible ambient conditions	
Temperature range (in use):	-30 °C and +60 °C
Storage:	-30 °C and +60 °C



certificate
no. **PS 16060010**
dated **2016-04-13**

Translation In any case the German original shall prevail

European notified body
Identification number 0299

*This certificate replaces
certificate no. 14060053*

EC-Type Test Certificate

Name and address of the holder of the certificate: (customer) AuG Kiel GmbH
Warnauer Weg 4
24245 Kirchbakau
Germany

Product designation: **anchor device type B**

Type: Universalanschlagpunkt U/S WEA

Testing based on: EN 795:2012-07 (D)

Test report: 16 1 0094

Further details: Prod.-Id. 13 1 0596 / augki / anschlagpunkt u/s-wea

Observations on the first aid (page 21) and probe system for use in rescue system AuG-Lifeguard 3600 (pages 24 and 25) in the user's instructions are not the subject of the assessment and not included in the scope of certification.

Intended purpose:
anchor device with an anchor point for systems of the personal fall protection equipment according to EN 363:2008

This product is a personal protective equipment of category III in accordance with the directive 89/686/EEC; control measures to article 11 are required. The product tested complies with the essential requirements of Annex II of the directive 89/686/EEC (**Personal Protective Equipment**), amended by the directives 93/68/EEC, 93/95/EEC and 96/58/EC.

The present certificate is valid until: **2019-12-17**

Further provisions concerning the validity, the extension of the validity and other conditions are laid down in the Rules of Procedure for Testing and Certification.

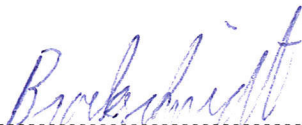

Signature Dipl.-Ing. (FH) Brockschmidt



Postal address: Zwengenger Str. 68 / 42781 Haan
Phone./Fax: +49 (0) 21 29 / 576-431 / +49 (0) 21 29 / 576-400 E-Mail: psa-zs@bgbau.de
Internet: www.zs-bgbau.de



Deutsche
Akkreditierungsstelle
D-ZE-17009-05-00

Example showing the CE marking



To the CE marking of PPE of category III will be added the identification number of the notified body carrying out the control measures.
